



RETAIL & WORK SPACE @ **MEHSANA**



Action is Foundational  
Key to All Success...



Radhe Govind, a business center is the latest offering by **Radhe Group** in the happening place of Mehsana. Commerce is an integral part of our lives. May it be retails, workspaces or other commercial ventures, the space from where we operate our business, defines the success. Mehsana has been a prime business district for such growth, with massive developments both in the residential as well as commercial segments. Radhe Govind - a state of the art complex - is strategically located on one of the busiest junction near Gopi Nala. The proximity to many residential areas and commercial zones offers complete convenience to the proud owners of Radhe Govind and the users.

It's Time to MOVE ON...  
The New Horizon  
Business with SUCCESS...





The Most Effective way  
to Get Your Success...



radhe GOVIND



radhe GOVIND





### LOCATION MAP

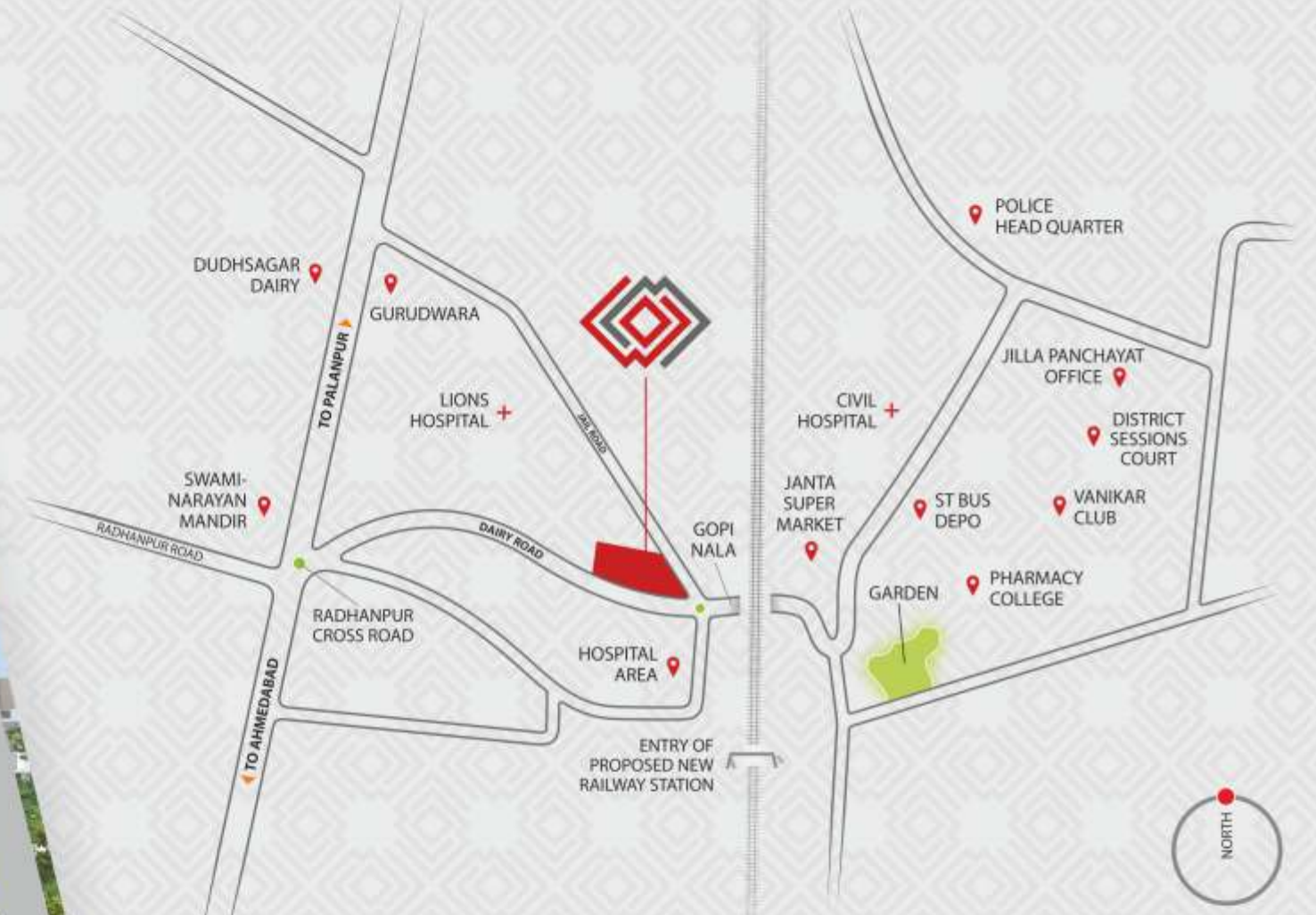

radhe GOVIND

STRATEGIC LOCATION



Connect with Excellent  
Business Success...





A Place Where You Can  
Focus on Your Growth...



  
radhe GOVIND

**ELEGANT WORKSPACE**





Eventuality for all...

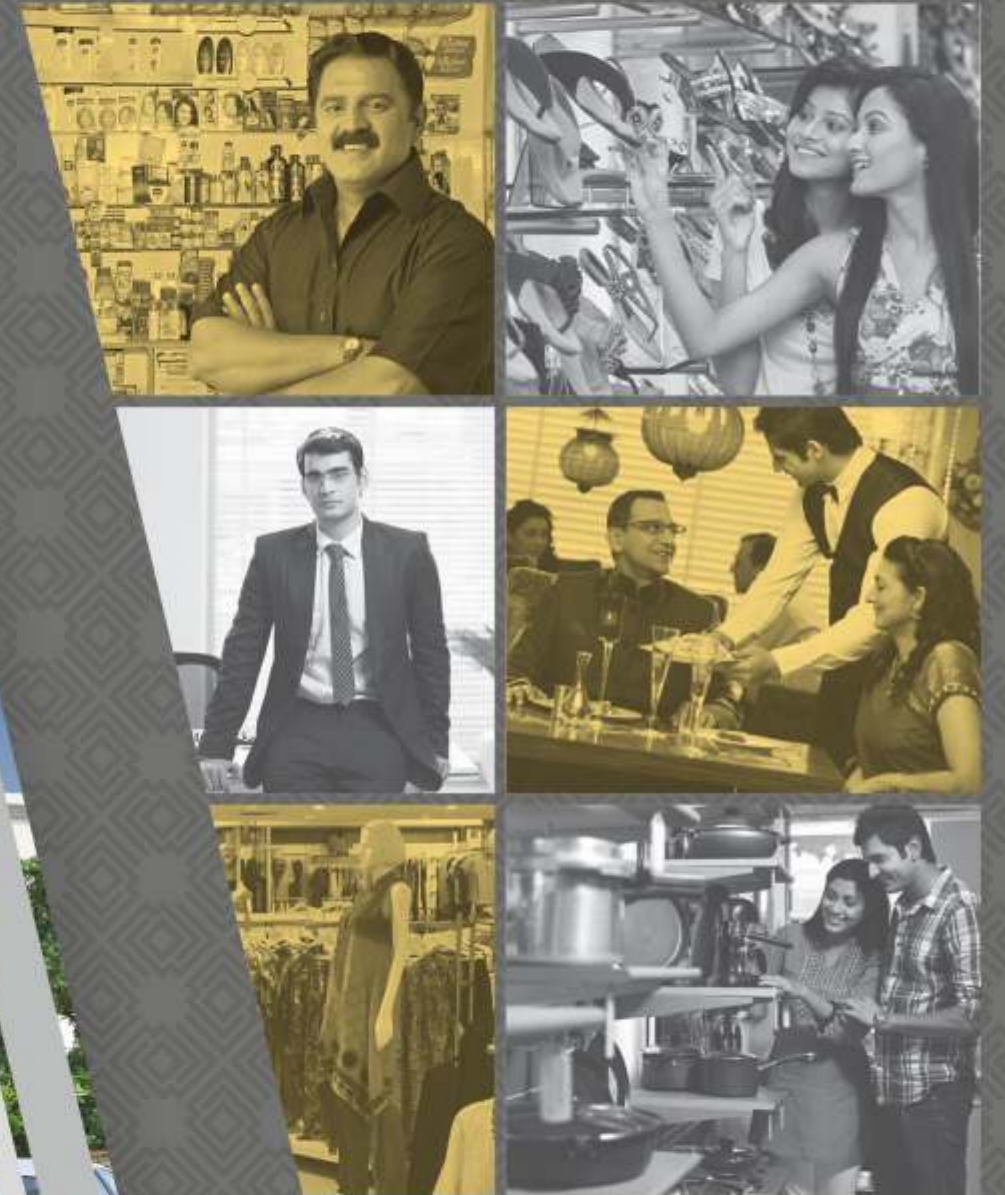

OFFICES | BANK & ATM | APPARELS  
SUPER STORE | MEDICAL STORE  
GYMNASIUM | FURNITURE | JEWELRY  
HAIR & SPA | ELECTRONICS & MANY MORE...





## STAR FEATURES

Features That Help to Increase Your Business...



- Earthquake resistant structural design.
- Futuristic elevation with all modern amenities.
- A spacious and elegantly landscaped plaza.
- General toilets of adequate size on upper floors and attached toilet in each shop.
- Wide passages at each floor.
- Good quality branded lift.
- Provision for electric meters and allocated space for AC outdoor unit.
- TV points in offices and shops with cable provision of DTH service.
- Permission of sign board as per developer rights and rules.
- Provision of generator for common lighting and lift.
- 24 hrs CCTV for security.
- WI-FI Enabled Complex.





# GROUND FLOOR PLAN

- OPEN LAND FOR FUTURE POSSESSION
- POSSIBLE FUTURE DEVELOPMENT
- ENCROACHMENT IN DP ROAD







# FIRST FLOOR PLAN

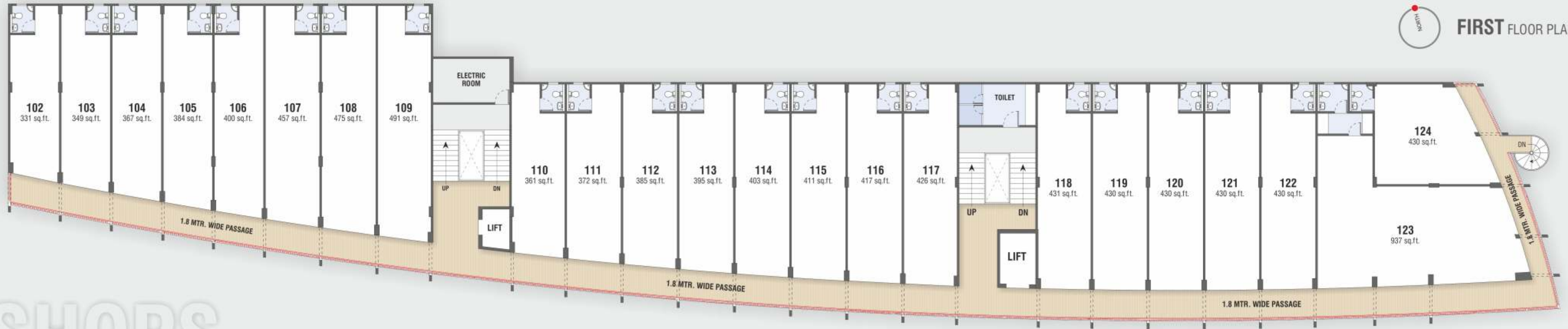

SHOPS



# SECOND FLOOR PLAN

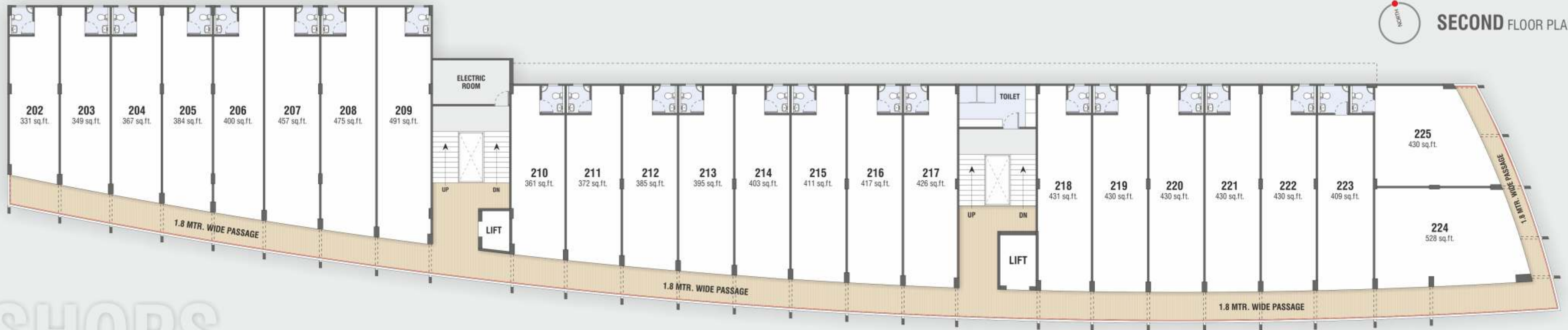

SHOPS





## SPECIFICATIONS

- **WALLS :**  
Internal smooth finish cement plaster with putty finish and external double coat mala plaster with textured treatment & acrylic paint.
- **FLOORING :**  
Best quality Vitrified tiles in all shops and offices.  
China mosaic flooring on terrace.  
Granite flooring in common passages, staircase and plaza.
- **DOORS AND WINDOWS :**  
Flush door shutters, full height structural glazing in offices and rolling shutters for shops.
- **STRUCTRE :**  
Earthquake resistant RCC frame structure with brick wall.
- **PLUMBING :**  
Premium quality corrosion free and leak proof cpvc/ upvc pipe fitting with branded sanitaryware and fixtures.
- **ELECTRIFICATION :**  
Concealed ISI copper wiring with modular switches.  
Good quality earthing.  
MCB distribution panel.  
TV cable points and telephone point in all shops & offices.  
3 phase connection to all shops & offices.
- **ELEVATORS :**  
2 premium quality passenger elevator with auto doors.

**RULES & REGULATION :** Stamp duty, Registration charges, legal charges, UGVCL charges including cable and substation cost and other government charges shall be borne by the purchaser as per actual. ● Any additional charges or duties levied by the government/local authorities during or after the completion on the project will be born by the purchaser as per actual. ● Extra work shall be executed after receiving full payment. No changes shall be allowed on the external elevation. ● The developers reserve the right to make any changes in the plan, information and specifications may be required without any prior notice. Such changes shall be binding to all the members. ● Maintenance deposit shall be paid separately by all members in advance. ● Polluting business is not allowed in premises. ● Irregular payment may lead to cancellation of booking. ● This brochure is just for an easy presentation of the project and should not be treated as a legal document. ● All rights are reserved by the developer of building's terrace. ● The developers reserve the rights to make required changes in plans, specifications, and features without any prior notice.





Project by  
  
**Radhe**  
 GROUP

Developer by  
**RADHE GOVIND**  
 PROJECT  
 MAHESH DESAI +91 98252 59266

 Site Address  
**Radhe Govind,**  
 Gopi Nala Junction,  
 New railway Station-  
 Approach Road, Mehsana.  
**www.radhegrp.com**

Architect  
  
 since 1992  
 associated architects (i) pvt. ltd.  
 Ahmedabad.  
 www.aapl-architects.org  
 Structure  
**SETU INFRASTRUCTURE**  
 AHMEDABAD

Legal Advisor  
**MR. R. D. SHAH**  
 (HIGH COURT ADVOCATE)  
 Electrification / Water Consultant  
**Aqua Utility Designs &  
 Management Pvt. Ltd.**

RERA Registration No. :