



Site : Radhe Palladium, Nr. Canada Palace, Radhe Circle,
Mehsana Bypass Highway, Mehsana.
Call : +91 98252 55337

Office : RADHE HOUSE, Nr. Radhe Kirtan Flats, Opp. Shahaj Flats,
Radhanpur road, Mehsana.
Call : +91 99250 26617



Target

4

Instate Success...



RADHE GROUP present a luxurious business space "*Radhe PALLADIUM*" in the heart of **Mehsana** near Radhe Circle, with all modern amenities in the vicinity. Choreographing the human experience in a way that is simultaneously pragmatic and inspiring, RADHE PALLADIUM is known for creating built environments that express the central idea at work, bringing all comfort at one place.

The **Prestigious**
Landmark to
announce
your business
success...



Radhe
PALLADIUM
COMMERCIAL HUB

Designed **4** Vitality



The Shimmering glass faced, breakthrough design and trendy style makes an impressive architectural statement. A vibrant hub of high-end showrooms, retail stores and lifestyle boutiques inviting the next generation to the world of shopping.

SHOWROOMS

GROUND FLOOR + FIRST FLOOR + BASEMENT COMBINED

OFFICES

SECOND FLOOR & THIRD FLOOR



Ideal Space

4 All Business...

PREMIUM
SHOWROOMS
& OFFICES FOR...

- ♥ Corporate office
- ♥ Bank & Atm
- ♥ Apparels
- ♥ Laboratory
- ♥ Furniture
- ♥ Electronics
- ♥ Insurance
- ♥ Automobile
- ♥ Clinic Space
- ♥ Spa
- ♥ Restaurant
- ♥ Call center
- ♥ & Many more...





Radhe PALLADIUM

Radhe PALLADIUM

Here, Creating growth story for you...

Address

4 Admire



LOCATION MAP



- The address of your business speaks volumes about you as an entrepreneur and showcases your company's image.
- Establish your business at the most prominent and posh location of Mehsana.
- **Radhe PALLADIUM** will be epicenter of business and growth.





BASEMENT PLAN

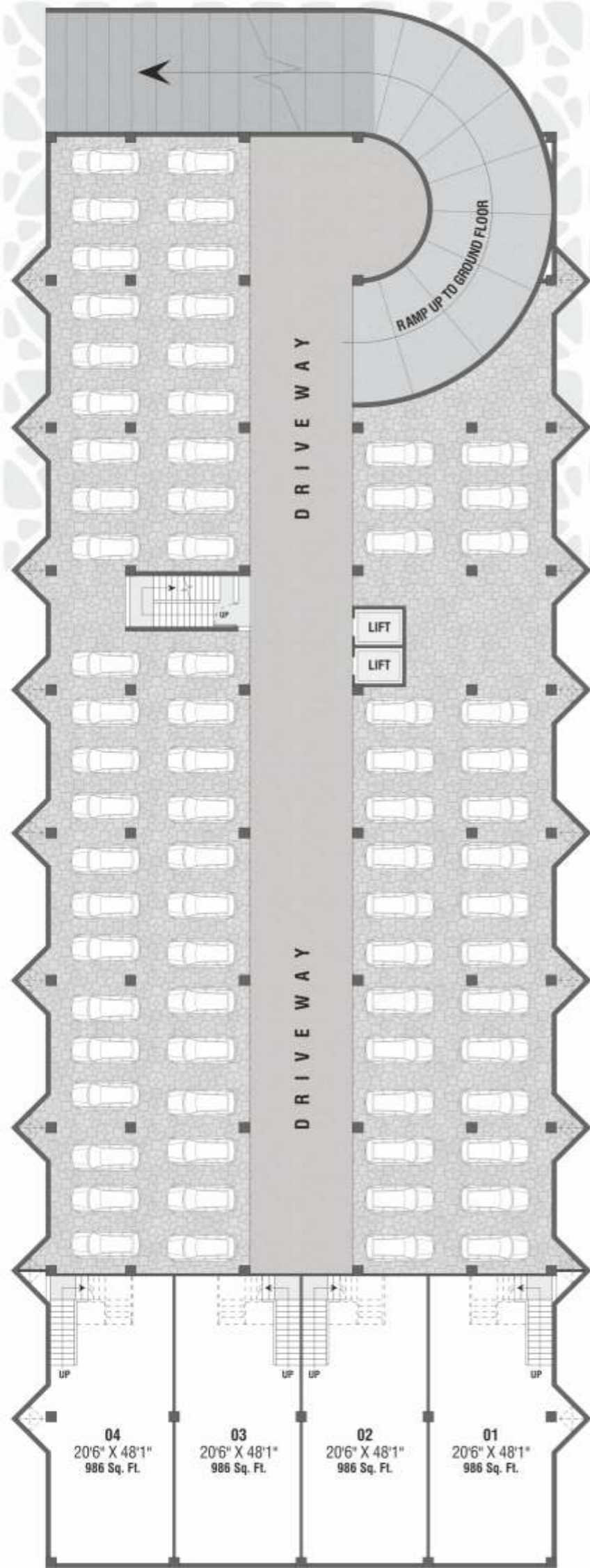

GROUND FLOOR PLAN

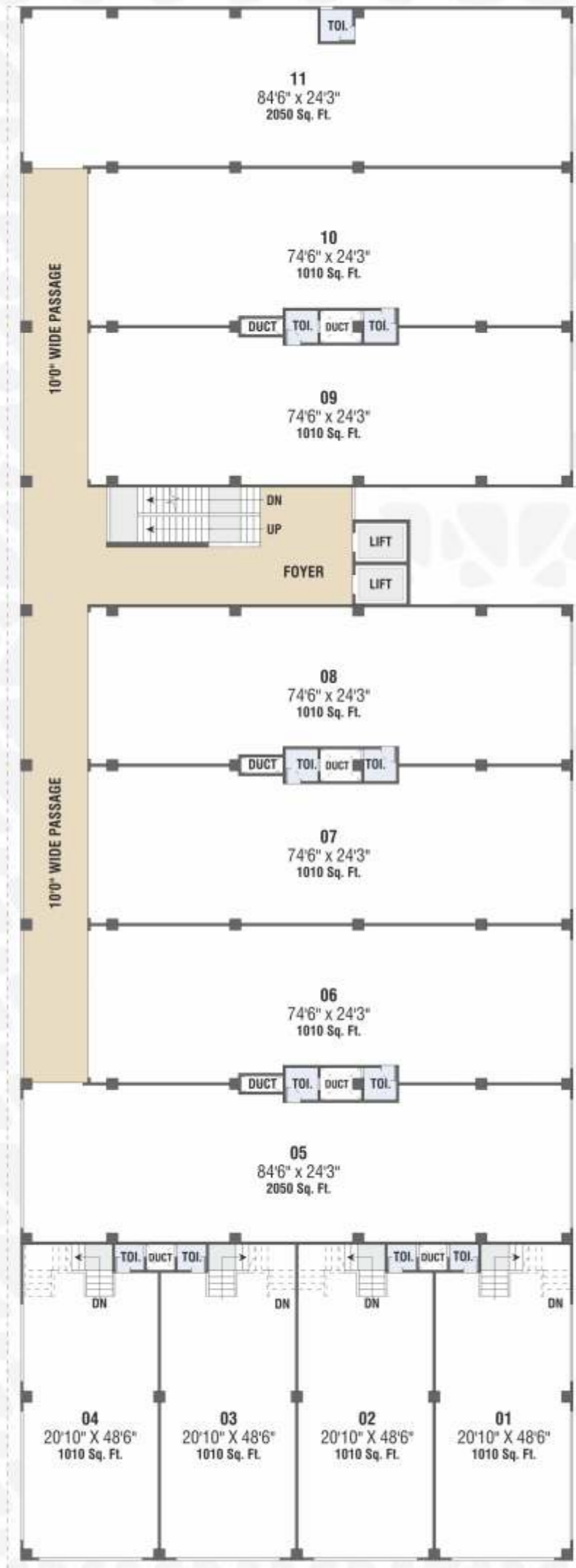

N
1st FLOOR PLAN



N
2nd FLOOR PLAN

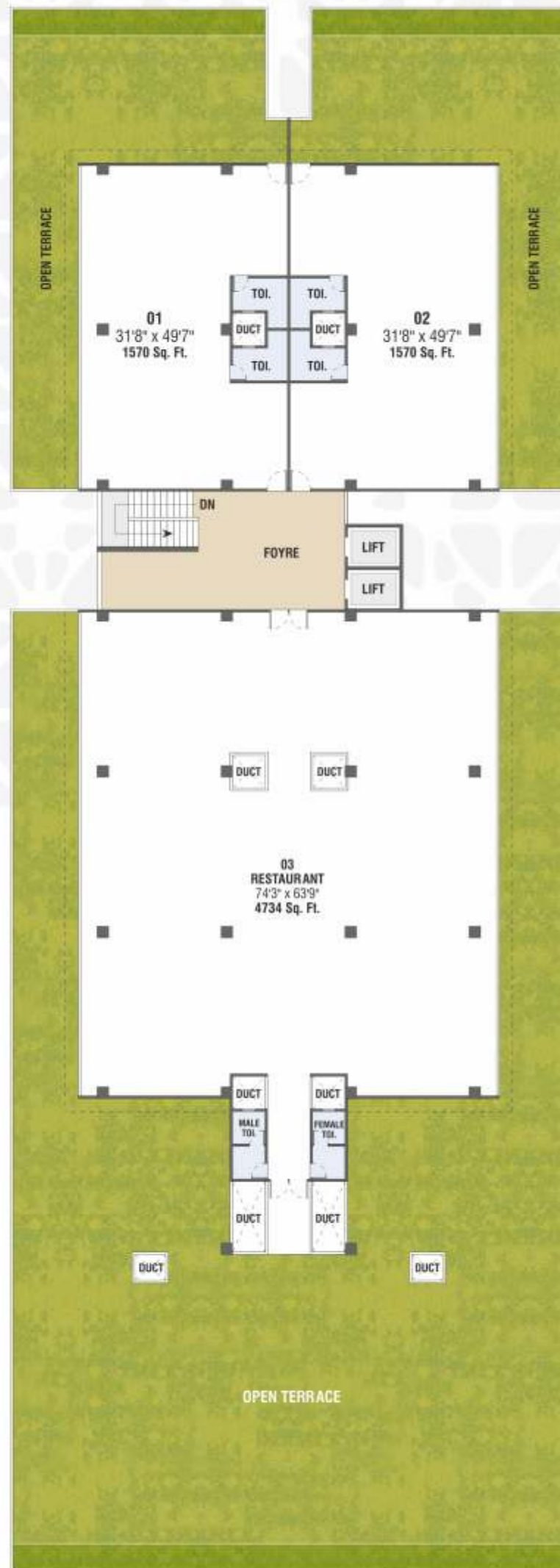

WHAT YOU PROCURE IT AFFECT!!!



Earthquake Resistance Structure



CCTV Camera Systems



24 x 7 Security



Basement with Guest Parking



High-Speed Elevator



24 x 7 Water Supply



SPECIFICATIONS



Structure
Earthquake resistance R.C.C. Frame Structure.



Wall Finish
Internal mala Plaster with white putty. External double coat Sand Faced plaster with acrylic paints.



Showroom/Offices/Shops
Good quality Rolling shutter / Door with oil paint.



Flooring
Good quality vitrified Tiles Flooring in entire unit.



Parking
Sufficient Parking in Front side of Ground Floor & Basement.



Electrification
Concealed copper wiring & good quality Accessories with sufficient Electric points.



Lift
Branded Automatic Lift for easy accessibility.

IMPORTANT NOTES

- Stamp duty, registration charges, GST, electric co. charges including cable and sub station cost and other government charges shall be born by the purchaser.
- Any additional charges or duties levied by the government / local authorities during or after the completion of the project will be borne by the purchaser.
- Extra work shall be executed after receiving full payment. No changes will be external elevations.
- The developers reserve the right to make any changes in the plans, information and specification as may be required without any prior notice. Such changes will be binding to all the members.
- Possession will be given after seven days of settlement of all accounts.
- Maintenance deposit shall be paid separately by all members in advance.
- This brochure is just for an easy presentation of the project and should not be treated as a legal document.
- Any legal conflict arises in future shall be governed by laws of India. And shall subject to jurisdiction of Mehsana city only.
- All rights reserved to developers for any change.

ARCHITECTS

PANDYA ASSOCIATES
AHMEDABAD

RAJKIRAN
MEHSANA

STRUCTURE

SETU INFRASTRUCTURE
AHMEDABAD